

## 2 5/8" Horizontal Sliding window Series 525

### I. GENERAL:

Scope of Work - Furnish all necessary materials, labor and equipment for the complete installation of aluminum windows for this project as shown on the drawings and herein specified. Windows shall be the Series 525 as supplied by Valley Aluminum Products Corporation. The Series 525 is a horizontal single slider with thermally improved frame and sash consisting of an operable, removable, sliding sash and a fixed side lite. The specifications and materials for the Series 525 are as follows:

### II. PRODUCTS:

Materials - Aluminum shall be of proper alloy for commercial window construction. All extruded sections shall be of 6063-T5 aluminum alloy.

Frame - Main frame and sash members shall be a nominal thickness as required by ANSI/AAMA 101. Main frame shall be 2.625" in depth. Vertical sash members shall be hollow extrusions. Main frames and sash members are to be extruded aluminum with a structural thermal barrier of high density low thermal conductivity polyurethane, poured and debridged.

Locks - Shall consist of a cam latch at the interlocking meeting rail along with an independent spring loaded latch for each sash.

Weather-stripping - Shall be .250 polypile with mylar fins conforming to AAMA 701.2, Specification for Pile Weatherstrip. Weather-stripping shall be doubled at all points of contact of the sash and main frames and at the interlocking meeting rail.

### III. CONSTRUCTION:

Assembly - Main frame shall be a mechanically joined construction. Corner joints should be "seam sealed" with a quality grade of sealant meeting the requirements of AAMA 803.3. The sash shall be assembled with two screws at each corner. All screws at joints of sash and main frame shall be secured into integral screw ports.

Glazing - Glass in the operable sash shall be factory glazed with a marine (wrap around) reusable vinyl glazing channel. The fixed side lite shall be inside

glazed, using a rigid vinyl glazing bead. The insulated glass units shall be .875" overall thickness with two panes of double strength glass, separated by a .625" air space for optimum insulation. All insulated glass units shall meet the requirements of the ASTM E 774 specification, Class "A".

Screens - Screen frame shall be of hollow extruded aluminum frames. Finish shall match the main frames and sash. Insect screening shall be fiberglass or aluminum wire secured with a vinyl spline. Screens shall be half length.

Finish - Shall be a factory applied baked polyurethane powder coat finish meeting the requirements of AAMA 603.8 for Pigmented Organic Coating on Extruded Aluminum. Standard colors available are bronze, white and creme. Bronze anodizing, clear anodizing and high performance AAMA 605.2 finishes are optional.

Operation - The "X" sash is operable on the "Series 525" horizontal single slider window and will slide open for ventilation. The sash rolls on four non-adjustable, bronze roller bearings and is removable from the interior for ease of maintenance. The "Series 525" is available in XO or OX configurations.

### IV. PERFORMANCE:

Structural - Shall meet the requirements of ANSI/AAMA 101-88, HS-HC40 specification.

Thermal - Shall meet the requirements of AAMA 1504.88 CRF 51/54.

Forced Entry - Shall meet the requirements for AAMA 1302.5 and ASTM F588 Load identification Level 30.

### V. INSTALLATION:

Qualifications - Only skilled mechanics with experience in this trade. Units shall be installed plumb, level, square and shall be secured in accordance with detailed shop drawings. A non-hardening sealant compatible with aluminum shall be provided by the installer and applied in sufficient quality to provide a weathertight seal between the window and surrounding construction.

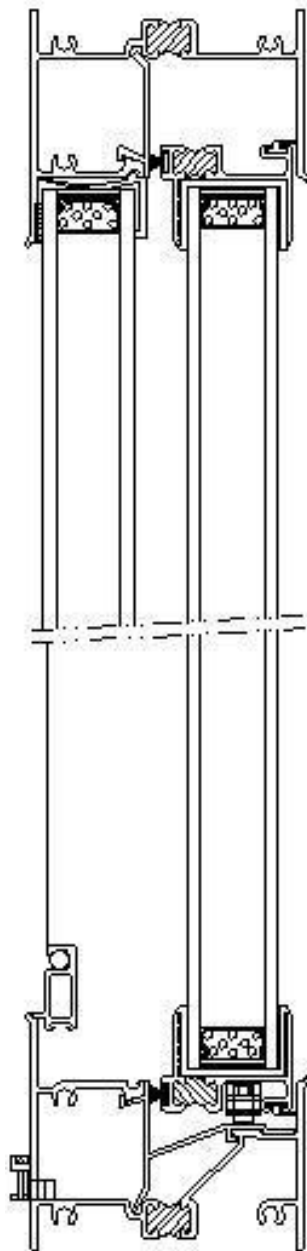

SERIES  
525  
HORIZON.  
SLIDER

